

# Feed Roller Assembly (Cat. # PO-703) Replacement Instructions

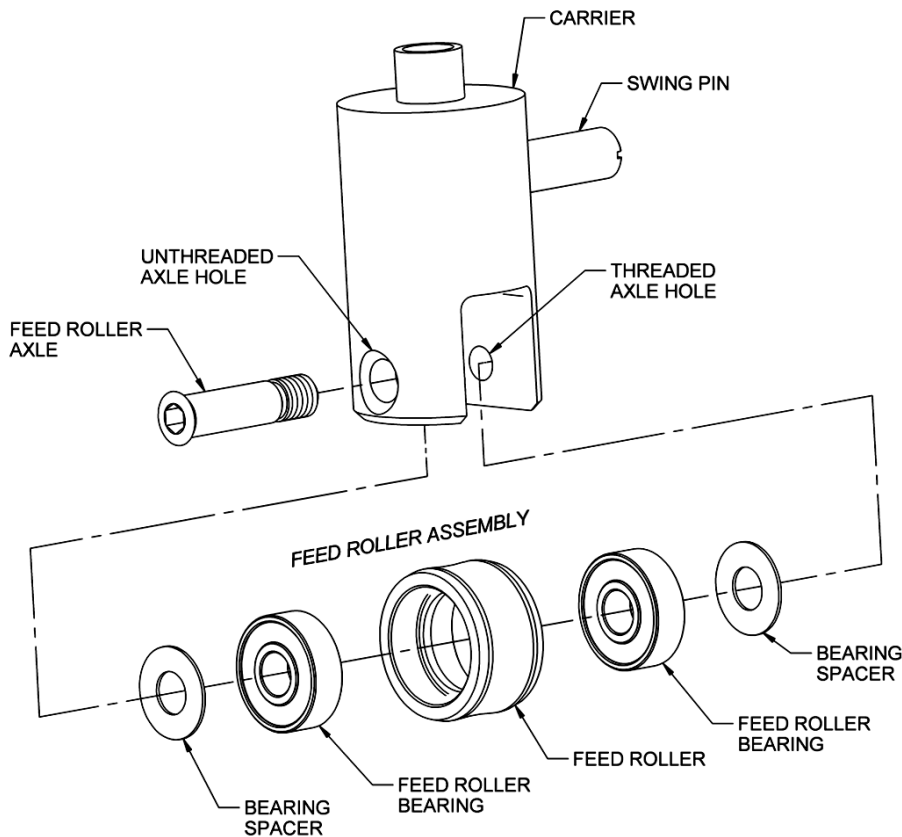

## **FEED ROLLER ASSEMBLY FOR:**

### Maxi-Rooter

Set of 3: PO-703 (#136110),  
Single: MX-7250, MX-7450  
(PO-450, #136120)

### Metro-Rooter

Set of 3: PO-703 (#136110)  
Single: ME-7250, ME7450  
(PO-450, #136120)

### Sewermatic

Set of 3: PO-703 (#136110)  
Single: ST1-7250, ST1-7450  
(PO-450, #136120)

### Speedroter

Set of 3: PO-703 (#136110)  
Single: S91-7250, S91-7450,  
S92-7703  
(PO-450, #136120)

### Sewerooter T-3

Set of 3: PO-JR-703 (#136110)  
Single: PO-JR-250, PO-JR-450  
(PO-450, #136120)

The replacement roller is an assembly consisting of one (1) Feed Roller, two (2) Feed Roller Bearings, and two (2) Bearing Spacers.

**\*Note: The Bearing Spacers must be installed between the Carrier and each Feed Roller Bearing (as illustrated above) in order to ensure proper operation and to obtain maximum Feed Roller life.**

### **To Replace the Feed Roller Assembly:**

1. Remove the Feed Roller Assembly by unscrewing and removing the Feed Roller Axle.
2. For convenience, the components are assembled and wired together at the factory. Before attempting to install the assembly, hold the assembly together and remove the wire.
3. While still holding the Feed Roller Assembly together, insert it into the slot opening of the Carrier.
4. In order to help align the Spacers and Bearings, insert a pencil point or similar object through the **un-threaded** end of the Axle hole in the Carrier. After removing the pencil point, continue to maintain the alignment of the components.
5. The Feed Roller Axle should then be inserted through the same un-threaded Axle hole and should continue to be guided through the Spacers and Bearings to the threaded Axle hole on the other side of the Carrier.
6. Securely tighten the Axle to the Carrier with a 3/16" allen wrench.