

MINI-ROOTER XP PARTS LIST

CAT. NO.	DESCRIPTION	CAT. NO.	DESCRIPTION
XP-100-2	Complete Frame Assembly	XP-307	Belt Guard
XP-100-R	Complete Frame Assembly (Orange)	XP-308	Air Switch & Reverse Switch Assembly
XP-101-2	Frame Only	XP-308-R	Air Switch & Reverse Switch Assembly
XP-101-R	Frame Only (Orange)	XP-308-A	Box Only w/Cover & Screws
XP-102-1	Rubber Leg Tip (2)	XP-308-B	Foot Pedal & Hose
XP-103	Rubber Foot, Washer & Nut (2)	XP-308-C	Cable Tie
XP-104	Drum Shaft Retaining Pin	XP-308-D	Foot Pedal Only
XP-104-A	Retaining Pin Spring	XP-308-E	Power Switch Diaphragm
XP-104-B	Retaining Pin Collar w/Set Screw	XP-308-F	Air Hose Only
XP-105	Shaft Spacer w/Set Screw	XP-308-G	Reverse Switch (3-Way)
XP-107-1	Folding Handle	XP-308-G-R	Momentary Contact Reverse Switch (Red)
XP-107-R	Folding Handle (Orange)	XP-308-K	Switch Guard
XP-108	Rubber Tip (2)	XP-308-N	Strain Relief Nut
XP-110	8" Wheel (2)	XP-309	Motor Guard w/Nylon Strip
XP-111	Wheel Retaining Cap (2)	XP-309-A	Nylon Strip
XP-112	Wheel Spacer (2)	GFI-10	Ground Fault Circuit Interrupter w/10' Cord
XP-115	Front Post	PO-XP	Complete XP Power Cable Feed
XP-115-R	Front Post	PO-XP-R	Complete XP Power Cable Feed for Rental
XP-116	Post Locking Knob	PO-MR-101	Power Feed Body
XP-117	Post Support Bracket	PO-MR-101-A	Spout
XP-118	Guide Tube Holder	PO-MR-102	Lifting Spring
XP-119	Bolt w/ Lock Washer	PO-MR-200	Feed Roller Assembly
XP-200	Complete Drum Assembly w/Inner Cage (Closed)	PO-MR-200-R	Feed Roller Assembly for Rental
XP-200-O	Complete Drum Assembly w/Inner Cage (Open)	PO-MR-210	Carrier Only
XP-201	Drum Shell	PO-MR-210-R	Carrier Only for Rental
XP-201-R	Open Drum Shell	PO-MR-220	Swing Pin
XP-201-A	Edging	PO-MR-220-R	Swing Pin for Rental
XP-202-1	Drum Shaft	PO-MR-225	Feed Roller Shaft
XP-202-A	Front Shaft Retaining Ring	PO-MR-250	Feed Roller
XP-202-B	Flat Washer	PO-MR-301	Feed Pressure Knob Assembly
XP-202-C	Felt Washer	PO-MR-315	Outer Pressure Spring
XP-202-D	Rear Shaft Retaining Ring	PO-MR-330-1	Washer
XP-203	Rear Hub Assembly w/Bushing	PO-MR-510	Bottom Roller Assembly Retaining Snap Ring
XP-203-B	Screws & Flanged Locknuts (5)	PO-MR-530	Thrust Washer
XP-204	Distributor Tube and Inner Drum Assembly	PO-MR-601	Feed control Disc w/Lever & Knob
XP-204-1	Flexitube Distributor Tube Assembly	PO-MR-601-A	Lever & Knob
XP-205	Fiber Washer (3)	PO-MR-602	Control Disc Retaining Snap Ring
XP-206	Front Hub w/Bushing (Orange)	PO-MR-703	Set of Feed Rollers (3)
XP-206-R	Front Hub w/Bushing (Silver)	PO-MR-800	Feed Mounting Assembly
XP-207	Round Head Cap Screws (4)	PO-MR-820	Mini-Rooter Mounting Plate
XP-208	Distributor Tube Front Collar w/Set Screw	PO-MR-821	Bolts & Washers (2)
XP-209-1	Inner Drum Cage	PO-MR-830	Upper Mounting Bar w/Set Screws
XP-210	Drum Connecting Cable	PO-MR-831	Set Screws (2)
XP-210-A	Connecting Cable Bolt, Nut & Washer	PO-MR-840-1	Upper Clamp Assembly
XP-216	Inner Drum Retaining Bolt	PO-MR-841	Upper Clamps
XP-217	Drum Retaining Washer	PO-MR-842	Slot Head Screw
XP-218	Felt Washer	PO-MR-843	Carriage Bolt
XP-219	High Collar Lock Washer	PO-MR-844	Knob
XP-300	Motor 1/3 hp w/GFCI, Air Foot Switch, & Rev. Switch	PO-MR-845	Spring
XP-300-R	Motor 1/3 hp w/GFCI, Air Foot Switch, & Rev. Switch	PO-MR-846	Cone Spring
XP-302	Belt Guard Retaining Knob	PO-MR-847	Lock Nut
XP-302-A	Washer	PO-MR-850-1	Lower Mounting Bar
XP-303	V-Belt Pulley	PO-MR-851	Socket Head Cap Screw & Lock Washers (2)
XP-303-1	Safety Slip Clutch	PO-MR-870	Lower Clamp Assembly
XP-304	Motor Support w/Nuts, Bolts & Washers	PO-MR-871	Lower Clamps
XP-304-A	Nuts, Bolts & Washers (4)	PO-MR-873	Nuts & Bolts (2)
XP-304-B	Guide Screws (2)	MR-GT	Guide Tube
XP-305	Motor Support Spring	XP-DVD	Instructional DVD
XP-306	V-Belt (45")	XP-DECALS	Set of Safety Decals

MINI-ROOTER XP SCHEMATIC DIAGRAM

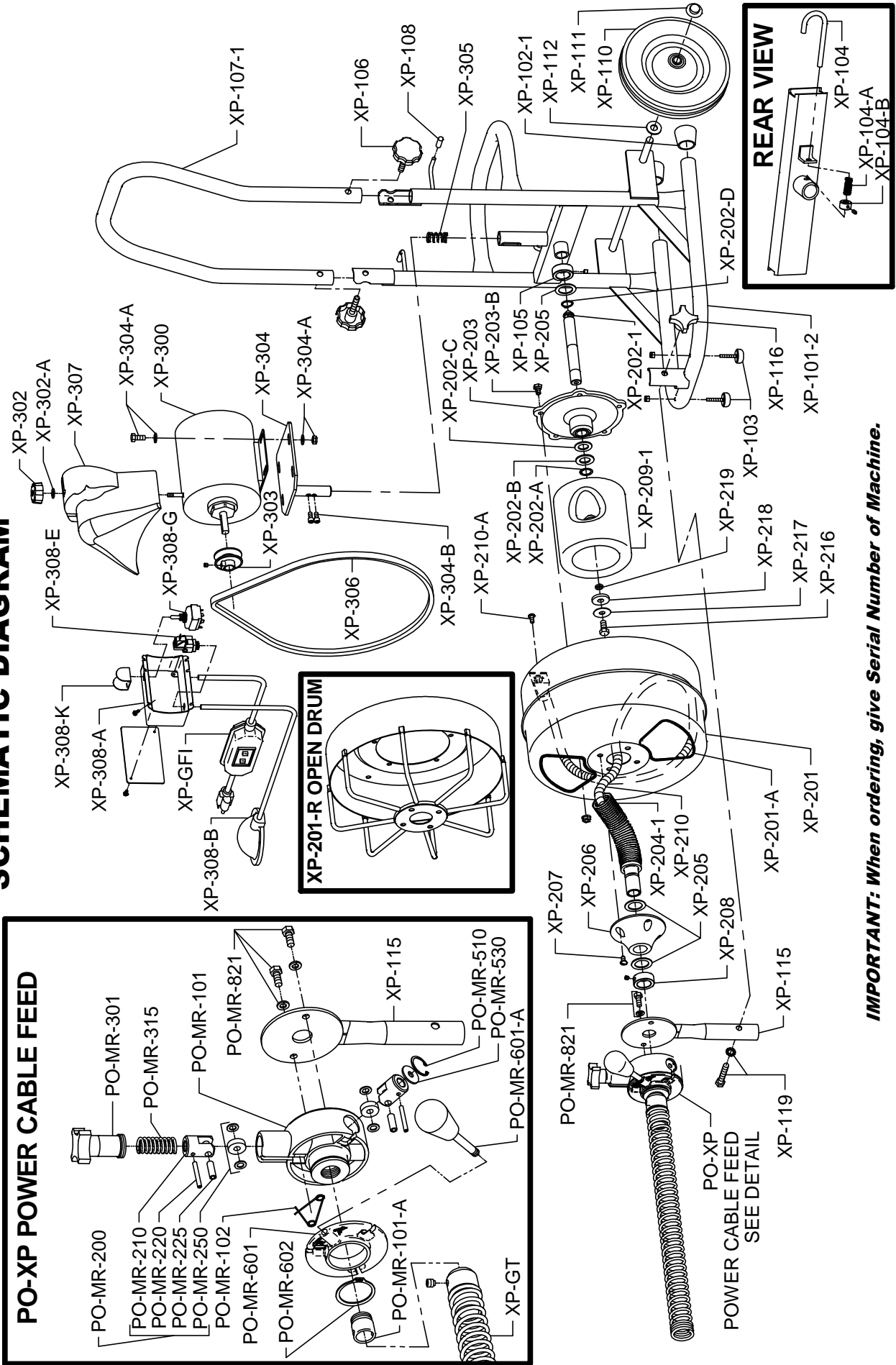

IMPORTANT: When ordering, give Serial Number of Machine.