

I-95 PARTS LIST

CAT. NO.	DESCRIPTION	CAT. NO.	DESCRIPTION
95-100	Frame Complete	95-245-A	Handle Only
95-101	Frame Only	95-245-B	Rubber Grip
95-102	Rubber Feet, Bolts, Nuts & Washers (2)	95-245-C	Bolt & Nut
95-103	Rubber Leg Tips (2)	95-245-D	Handle Adjustment Screw
95-104	End Plugs (2)	95-25-O	Small Container (for 5/16" Cables)
95-106	Cutter Holder	95-401	Small Container Shell & Spindle
95-107	Screws & Washers (2)	95-403	Ball Bearing
95-110	Motor Guard	95-404	Mounting Collar w/Knob
95-111	Screws for Motor Guard (4)	95-404-A	Knob
95-115	Belt Guard	95-404-B	Set Screws (3)
95-116	Belt Guard Retaining Knob	95-404-C	Grease Fitting
95-118	Belt Tension Adjustment Screw	95-405	Flange Bearing Set (2)
95-200	Chuck Assembly	95-407	Fiber Washers (3)
95-201	Chuck Housing	95-408	Brake Disc
95-201-A	Chuck Housing Bolts (4)	95-409	Spacer
95-201-B	Chuck Housing Bushing	95-410	Slotted Tube
95-201-C	Access Panel w/Screw	95-411	Snap Ring
95-201-D	Grease Fitting	95-35-O	Large Container (for 3/8" Cables)
95-202	Rear Housing	95-451	Large Container Shell
95-202-A	Rear Housing Bolts (2)	95-451-A	Container Front
95-202-B	Grease Fitting	95-451-B	Container Back
95-203	Brake Stop, Screw & Washer	95-451-C	Screws & Clips (3)
95-204	Brake Spring	95-452	Spindle for Large Container
95-205	Brake Sleeve	95-456	Washer (2)
95-210	Linkage (4)	95-457	Thrust Bearing Race
95-211	Sleeves (6)	95-465	Nut
95-212	Button Head Cap Screw (6)	95-600	1/3 hp Motor w/Reverse Switch & GFCI
95-213	Linkage Spacers (4)	95-601	Motor Pulley w/Set Screw
95-215	Yoke	95-602	Mounting Bolts, Nuts & Washers
95-216	Self Locking Nuts (2)	95-603	Notched V-Belt
95-220	Chuck Slide	GFI-10	GFCI w/10 ft. Power Cord
95-224	Threaded Collar w/Screws	95-605	Reverse Switch Assembly
95-225	Chuck Shaft	95-605-A	Terminal Boot
95-226	Ball Bearing	95-605-B	Wire Loom
95-230	Chuck Body	95-605-C	Cord Clamp & Screw
95-230-A	Set Screws (2)	95-605-G	Reverse Switch Only
95-230-C	Jaw Locating Ring	95-605-H	Toggle Boot
95-233	Jaw Springs (3)	95-605-J	Toggle Guard
95-234	Chuck Jaws w/Rings (3)	95-610	Baffle
95-235	Thrust Bearing & Races	95-611-1	Baffle Nuts (2)
95-240	Chuck Cone	95-612	Baffle Spacer Washers (4)
95-240-A	Limit Screw & Lock Washer	95-612-1	Baffle Spacer Washers (2)
95-242	Return Spring	95-613	Baffle Bolts (2)
95-245	Handle Assembly	95-RGH	Rear Guide Hose

IMPORTANT: When ordering, give Serial Number of Machine.

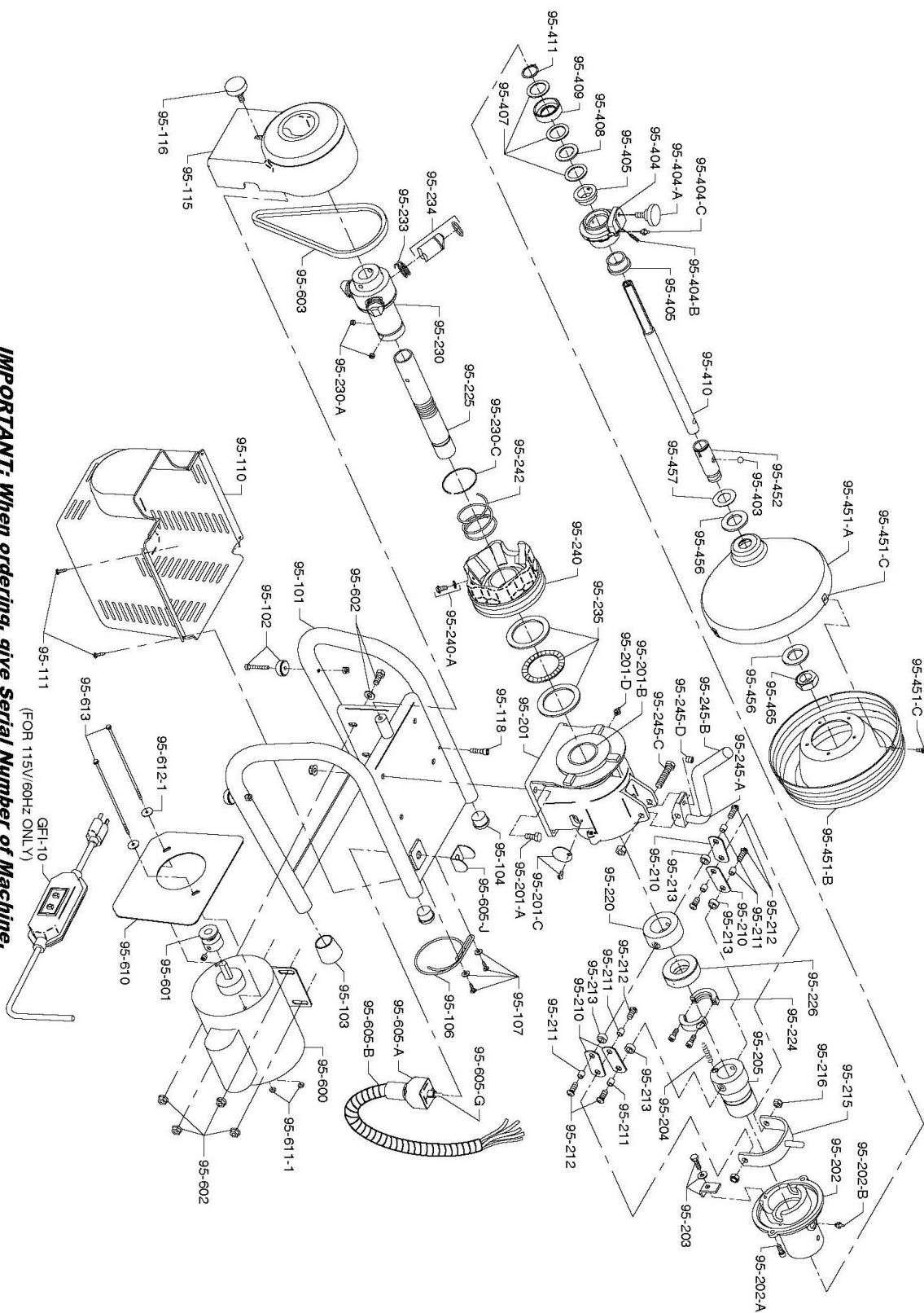

I-95 SCHEMATIC DIAGRAM

General Wire Spring Co,
1101 Thompson Avenue
McKees Rocks, PA 15136

412-771-6300

www.drainbrain.com